

Community Reference Group

LYSTERFIELD QUARRY

NEWSLETTER

ISSUE # 1

November 2017

Community Guides Action

Since the CRG was formed, members have raised a number of key concerns about operation of the quarry with Hanson. Discussions have resulted in Hanson changing their operational processes to respond to our concerns.

Changes include:

- In conjunction with Boral, Wellington Road from xx to Stud Road is swept six days per week.
- Hanson is utilising innovative methods to mitigate dust. A specialist product is now applied to stockpiles and internal roads to suppress dust; the truck tarping area has been sealed; a new water cart for dust suppression on internal roads is in use and a wheel wash for all vehicles leaving the site has been constructed.
- Hanson has now fixed blasting times and upon request, they will text you prior to a blast. Register by calling office during business hours.
- Every blast is monitored by Hanson for vibration and dust. As well as on site, monitors are located on neighbouring properties.
- Hanson has consistently encouraged all members to actively participate in the future planning of the rehabilitation program. Collectively, or individually, members have provided ideas and concepts that Hanson are now considering.

The Wellington Road Campaign

At our second meeting in June 2016, members expressed their concerns about trucks speeding down Wellington Road, running the red light at Wellington Village Shopping Centre and utilising neighbourhood streets as a shortcut.

So, we wrote to a number of agencies and government representatives inviting them to attend one of our meetings. These included:

- VicRoads, who declined the invitation.
- VicPolice, who declined the invitation, but advised they had conducted a four week campaign at the end of 2016 with no offences observed or reported.
- The Hon Kim Wells MP, State Member for Rowville, in response to a constituency question to the Minister for Roads and Road Safety about the issue. Mr Wells declined our invitation.
- The Hon Luke Donnellan, Minister for Roads and Road Safety, who declined our invitation.
- Mayor Darren Pearce, City of Knox, who accepted our invitation and attended our meeting on 25 October, 2017.

Hanson has distributed flyers to truck drivers as they leave the site and erected signs at the exit of the quarry to remind truck drivers of their responsibility to respect traffic laws.

About the Community Reference Group

The Lysterfield Quarry Community Reference Group (CRG) was formed in April 2016. It comprises 13 community members who live near, work close by or have an interest in the Lysterfield Quarry and its environs. The CRG is chaired by Mr Brian Oates, a former Mayor and Councillor of the City of Casey, and meets every few months for presentations from Hanson, government representatives and operational specialists. Most importantly, CRG members provide information to Hanson and contribute to the review of operational practices that provide greater benefit to the community.



L to R: Wendy Belli, Alice McKenzie, Trevor Harley, Virginia Bright, Gina Mastromano, Sally Orr, Doug Smith and Chairman – Brian Oates.

Absent: Clayton Collins, Rob Crundwell, Trudi Dicker, John Farrar, Paul Lees and Shane Logan

What we've learned

Not only are CRG meetings a good opportunity for us to voice our issues or concerns to Hanson, but it is a great opportunity for us to learn about what the quarry does and how it does it.

At every meeting, Hanson provides us with an update of their operations, and at most meetings we get information from a government agency representative, a Council representative, a specialist consultant or a Hanson manager of the relevant division.

The most important thing we have learned is that running a quarry is a meticulous process. It requires comprehensive environmental management and constant reporting to Earth Resources Regulation, a division of the Department of Environment, Land, Water and Planning; EPA Victoria and the City of Knox.

We have been on a tour of the site and seen first-hand how Hanson works to a clearly defined blasting plan, minimising vibration, dust and visual impacts. And, most importantly, how Hanson is rehabilitating and regenerating the land as it moves through the work area of the site.

End use of the quarry product on major projects is reported by Hanson at our meetings. During the past 12 months, Hanson has supplied product for the upgrade of the Melbourne Metropolitan freeway system and the removal of railway crossings across the south-eastern metropolitan area.

Finally, we have learned that Hanson appreciates contact with their local community. The information we provide helps them to be a better neighbour and run a better business.

What others have learned

Last year, through the KIOSC program, Hanson hosted and supported seven Rowville Secondary School Year 10 science students who learned about the quarry, its processes and the need for a rehabilitation plan relevant in 30 years' time. The students developed two concepts. A University with student accommodation and recreational sporting area that included a flora and fauna park. Both concepts were unique, forward-thinking and will make a great contribution to the discussion and design of the final design of the site.

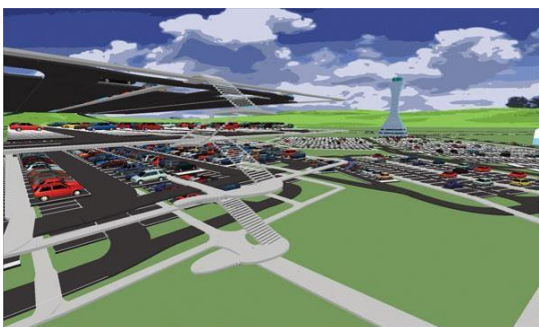

The student's Impression of the university car park

Any ideas?

Although still 30 years away, Hanson welcomes ideas for rehabilitation of the site. An updated plan needs to be developed for consideration by the City of Knox and the State Government. So far, we have supported the KIOSC students' presentation, heard about a water park, seen the results of overseas quarry rehabilitations including parks and gardens, retail centres, a geodesic dome and even a 4,500 seat open air theatre. If you have an idea

GET IN TOUCH

with the **Community Reference Group**

Email: community.lysterfield@hanson.com.au

with **Hanson Lysterfield Quarry**

Phone during business hours: 03 9274 3700

Unlikely Neighbours



While many of the CRG members are direct or nearby neighbours of the quarry, the nearest neighbours are the horses that are agisted at the Hillview Park Equestrian Centre located at the front of the Lysterfield Quarry.

Hillview Park has facilities catering type of rider and their horse's needs - from Pony Clubs to EA members through to trail or companion horses.

Of what we have learned about the horses, the risks from local residents who can impact their well-being and safety, has come as a surprise.

Some local residents, often well-meaning, deposit their lawn clippings or garden waste in the paddocks for the horses' pleasure. In fact, it is a horse and owner's nightmare. Chopped up lawn clippings are swallowed by the horses without chewing. That means saliva has not diluted the grass, resulting in colic and intestinal tract complications. Also, plants poisonous to horses can be found in bush and tree prunings. So, for the sake of the horses, please don't dump your garden waste in the horse paddocks.

Also, with summer holidays approaching, parents need to be sure that children are not playing in the paddocks, accessing stock dams, or mingling with stock on the property. Reminder – these are both private properties and trespass laws apply.